

PRODUKTBESCHREIBUNG

» Adapter für die Verwendung mit Schlauch-Montagevorrichtung E 21990

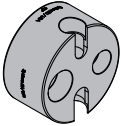
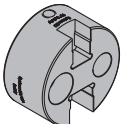
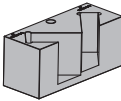
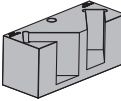
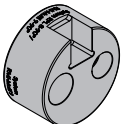
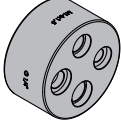
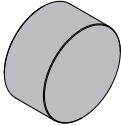

	Für	d1	b	d	h	l	Nr.	EUR
	System EU System USA System EU 90° System USA 90°	9 / 13	-	78	-	41	E 21992/01	< >
	System EU Safety System USA Safety System EU Safety 90° System USA Safety 90°	9 / 13	-	78	-	41	E 21992/02	< >
	System EU 45° System USA 45°	9 / 13	125	-	55	50	E 21992/03	< >
	System EU Safety 45°	9 / 13	130	-	55	50	E 21992/04	< >
	System RPL 8 System RMI-Multi 9 System RPL 8 90° System RMI-Multi 9 90°	8 / 9 / 3/8	-	78	-	41	E 21992/05	< >
	Gewindetüllen	G 1/8" / G 1/4" / G 3/8" / M10 / M14	-	78	-	41	E 21992/06	< >
	Zur Eigeneinbringung der Ausnehmung	-	-	78	-	41	E 21992/07	< >

i Detaillierte Auswahlhilfe siehe Verwendungsempfehlung Adapter

BEISPIEL FÜR AUSNEHMUNG E 21992/07

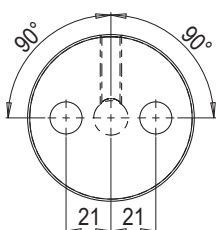

VERWENDUNGSEMPFEHLUNG ADAPTER E 21992

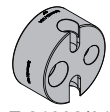

E 21992/01



E 2200/ 9/ 9
E 2200/13/13



E 22005/ 9/10
E 22005/13/13



E 2204/ 9/ 9
E 2204/13/13



E 22045/ 9/10
E 22045/13/13



E 2350/ 9,4/ 9
E 2350/13,5/13



E 23505/ 9,4/10
E 23505/13,5/13



E 2354/ 9,4/ 9
E 2354/13,5/13



E 23545/ 9,4/10
E 23545/13,5/13

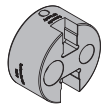

E 21992/02



E 22006/ 9/ 9
E 22006/13/13



E 22046/ 9/ 9
E 22046/13/13



E 23506/ 9,4/ 9
E 23506/13,5/13

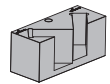

E 21992/03



E 2202/ 9/ 9
E 2202/13/13



E 22025/ 9/10
E 22025/13/13



E 2352/ 9,4/ 9
E 2352/13,5/13



E 23525/ 9,4/10
E 23525/13,5/13

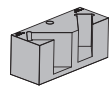

E 21992/04



E 22026/ 9/ 9
E 22026/13/13

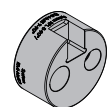

E 21992/05

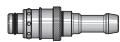

E 2820/ 8/...



E 28205/ 8/..



E 28218/...



E 28215/8/...



E 28335/ 9/...



E 28336/ 9/...



E 28314/3/8/...



E 28315/3/8/...

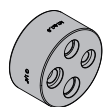

E 21992/06



E 2040/ 9/ 10

E 2040/13/1/4

E 2040/13/ 14

E 2040/13/3/8



E 20405/10/1/8

E 20405/13/1/4

E 20405/13/3/8